

User Manual

Connectors

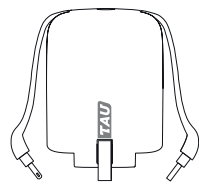

DUAL
(Apple
MicroUSB)

USB-C

DUAL

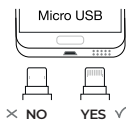
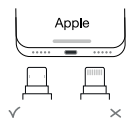

⚠ Do not force the wrong side into Micro USB port

Hook your Keys



⚠ Do not force the hook or it will be permanently damaged

OPEN THE HOOK
To open the hook, push it gently to the back side of TAU.

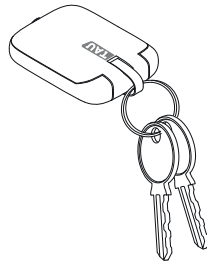

CLOSE THE HOOK
Insert your keys and snap the hook back in place.

Installation

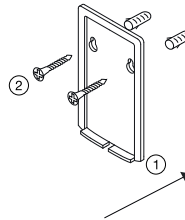

SCREW FIXING
Fix the back panel (1) of the dock to the wall using screws (2) in the box.

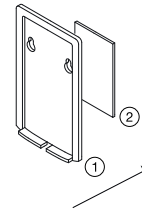

TAPE FIXING
Fix the back panel (1) of the dock to the wall or counter, using double sided tape (2) in the box.

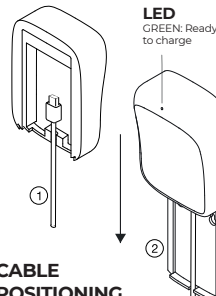

CABLE POSITIONING
Insert the cable (1) in the back of the case and slide the dock inside the back panel (2).

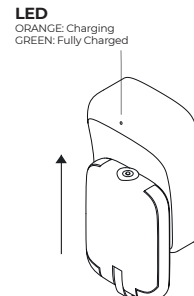

MAGNET
Slide-Up TAU on the front part of the dock to charge it.

LED
GREEN: Ready to charge

LED
ORANGE: Charging
GREEN: Fully Charged

Warnings and Specifications

Warnings

- ⚠ KEEP THE DEVICE OUT OF REACH OF CHILDREN.**
- ⚠ KEEP THE DEVICE AWAY FROM FIRE AND HIGH TEMPERATURE.**
- ⚠ AVOID DROPPING THE DEVICE.**
- ⚠ DO NOT SUBMERGE IN WATER OR EXPOSE TO ADVERSE WEATHER CONDITIONS.**
- ⚠ DO NOT OPEN OR PUNCTURE IT.**
- ♻ DO NOT DISPOSE OF LITHIUM POLYMER BATTERY WITH GENERAL WASTE. PLEASE DISPOSE OF IT IN A BATTERY RECYCLING COLLECTION POINT.**

Specifications

INPUT: 5V - 1A
OUTPUT: 5V - 1A
CAPACITY: 1400 mAh

